

## **LARGE WOOFER SPEAKER**

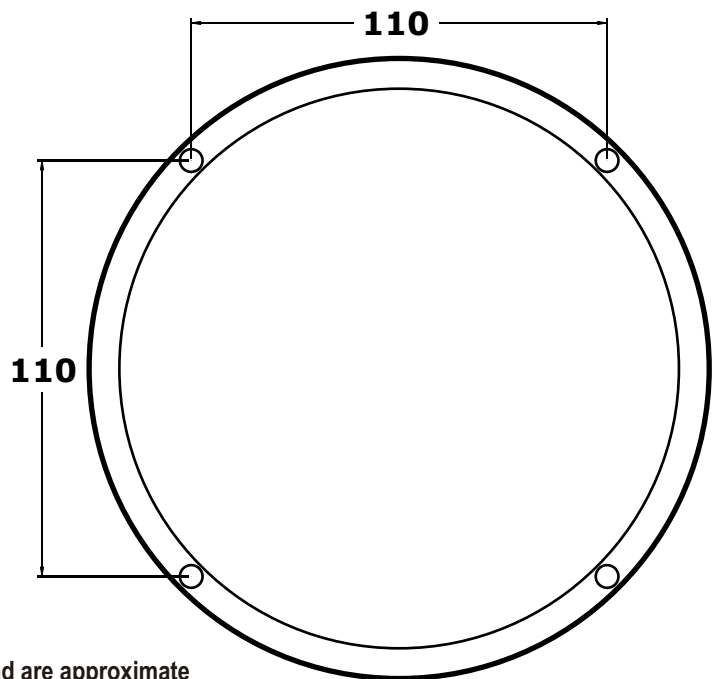

All dimensions in mm and are approximate

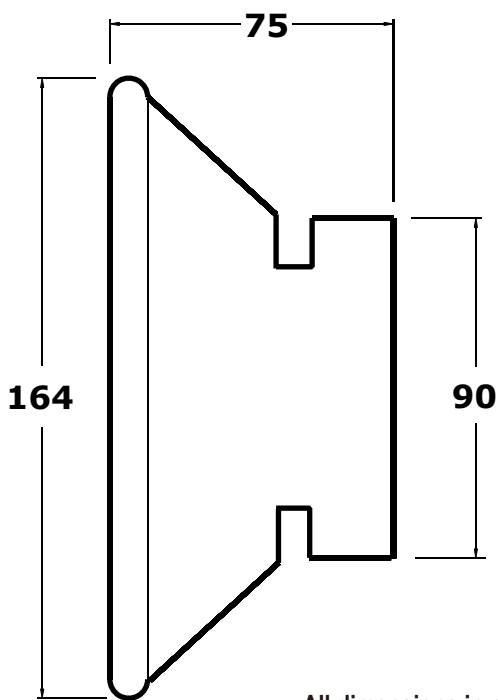

19 Carisbrooke Drive  
Nottingham NG3 5DS

**Clear polypropylene cone**  
**8 Ohm impedance**  
**Power: 40W RMS (60W peak)**  
**Frequency response: 44Hz-8kHz**  
**Magnet weight: 13 ozs**